



Model 1500i/2000i

Recirculating fume extraction is now extremely important with the rising concern for our environment and employee safety. Purex Fume Extractors provide not only a flexible and portable process for plant redesigns and expansions, but also a more stable process by providing a controlled airflow to remove harmful fumes. All this while eliminating the added costs of building modifications, increased air handling systems and lost energy.

Purex Digital Systems

- ❖ Automatic Flow Control maintains constant extraction rate
- ❖ Adjustable Air Flow extends filter life
- ❖ Blocked Filter Warning
- ❖ Easy to change filters
- ❖ Low energy consumption
- ❖ Quiet operation
- ❖ Welded stainless steel construction
- ❖ Reverse Air Flow prevents condensation and extends filter life
- ❖ Continuous run brushless motors
- ❖ HEPA filtration removes 99.997% of particles down to .3 microns
- ❖ Gas and particle sensors on exhaust
- ❖ Filter Blocked Monitor
- ❖ Gas Safety Sensor
- ❖ Particle Safety Sensor
- ❖ Motor Run Indicator
- ❖ Airflow reading
- ❖ Filtered air temperature
- ❖ Quick-read visual display
- ❖ Remote Machine Interface

1500i and 2000i Volume Control

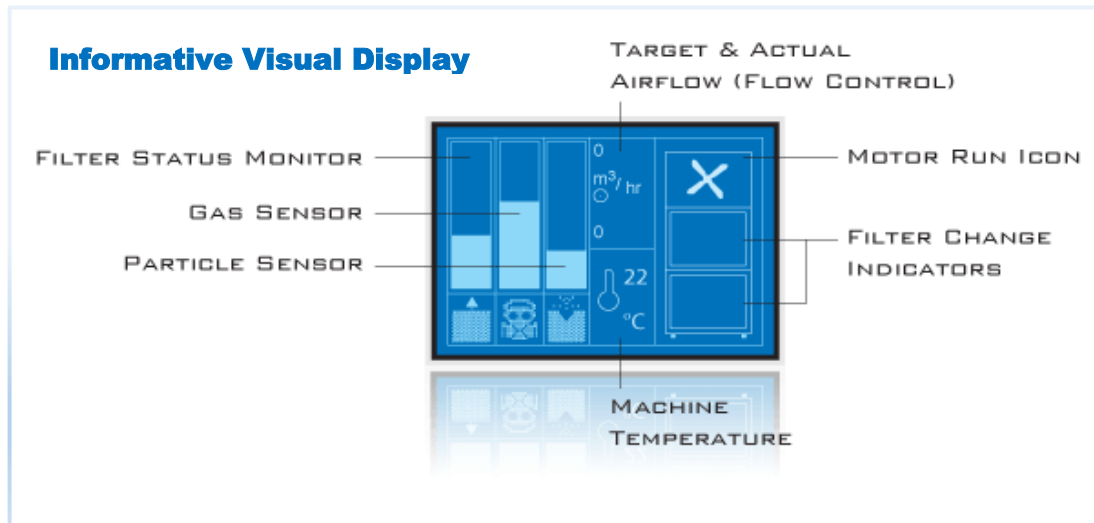

Main Filter Options



HEPA/Chemical	110615
HEPA/Twin Chemical	110614
HEPA Chemical Cleanroom*	110632
Chemical	110610

*Use F8/F9 Pre-filter

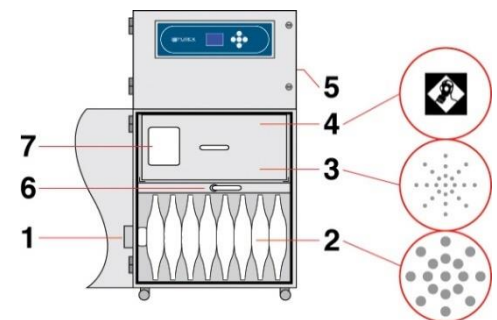

Labyrinth Pre-Filter Options



F6 (std) 60-80% eff 1-3 μ	111037
F8/F9 Composite >95% eff .5-1 μ	111099

- 1) Air inlet
- 2) Pre-filter
- 3) Main filter (HEPA)
- 4) Main filter (Carbon)
- 5) Clean air return
- 6) Filter lock Handle
- 7) Filter I.D. label

	1500i		2000i	
Model	0LX1511D	0LX1510D	0LX2011D	0LX2010D
Voltage (50hz/60Hz)	120v (1ph)	230v (1ph)	220v (3ph)	400v (3ph)
Wattage	3.4 kW		3.0 kW	
Airflow	1000 cfm (1700 m³/Hr)		1294 cfm (2200 m³/Hr)	
Vacuum	19 inwg (4.77 kPa)		25 inwg (6.28 kPa)	
Air Inlet	5.9in (150mm) Safe Seal			
Sound Rating	59 dBA			
Dimensions (L/W/H)	28.5in x 29in x 55.25in			
Weight	331 lbs			